



35 Pound Lane
Isleham, Cambridgeshire CB7 5SF
Offers In Excess Of £300,000

MA
Morris Armitage
01638 560221
www.morrisarmitage.co.uk

35 Pound Lane, Isleham, Cambridgeshire CB7 5SF

A detached bungalow delightfully nestling on the outskirts of this well served and popular village and enjoying a lovely aspect to rear overlooking an open field.

Offering generous size rooms throughout, this property enjoys accommodation to include entrance hall, sitting room/dining room, kitchen/breakfast room, lean-to conservatory, three bedrooms and family shower room with separate WC.

Externally the property offers an extensive driveway with ample parking for several vehicles, garage and a fully enclosed rear garden.

Council Tax Band C (East Cambridgeshire)
EPC (D)

Accommodation Details

Entrance Hall

Airing cupboard, radiator, doors and access through to:

Sitting/Dining Room 13'9" x 13'1" (4.2m x 4m)

Dual aspect room with windows to the rear and side, television connection point, radiator.

Kitchen/Breakfast Room 12'9" x 7'2" (3.9m x 2.2m)

Fitted with a range of wall and base storage units with working surfaces over, stainless steel sink with drainer, breakfast bar, oven with extractor hood above, space for fridge freezer, tiled splashbacks, tiled flooring, window to the side aspect, door through to:

Lean To 10'5" x 7'2" (3.2m x 2.2m)

With windows to the rear and side aspects, wall mounted heater, door leading out to garden.

Bedroom 1 12'5" x 9'10" (3.8m x 3m)

With window to the front aspect, radiator.

Bedroom 2 11'9" x 9'10" (3.6m x 3m)

With windows to the side and rear aspects, radiator.

Bedroom 3 8'10" x 8'2" (2.7m x 2.5m)

With window to the front aspect, radiator.

Shower Room

Comprising walk in shower with glass screen, pedestal hand wash basin, cupboard, radiator, part tiled walls, tiled flooring, obscured window to the rear aspect.

WC

Low level WC, radiator, tiled flooring, obscured window to the rear aspect.

Outside - Front

Picket fencing, paved driveway

providing off road parking, the rest of the garden is laid to shingle with shrub and hedge borders.

Outside - Rear

With countryside views the rear garden is laid mainly to lawn with patio area, timber fenced surround.

Garage

With up and over door, connected to power and lighting.



GROUND FLOOR

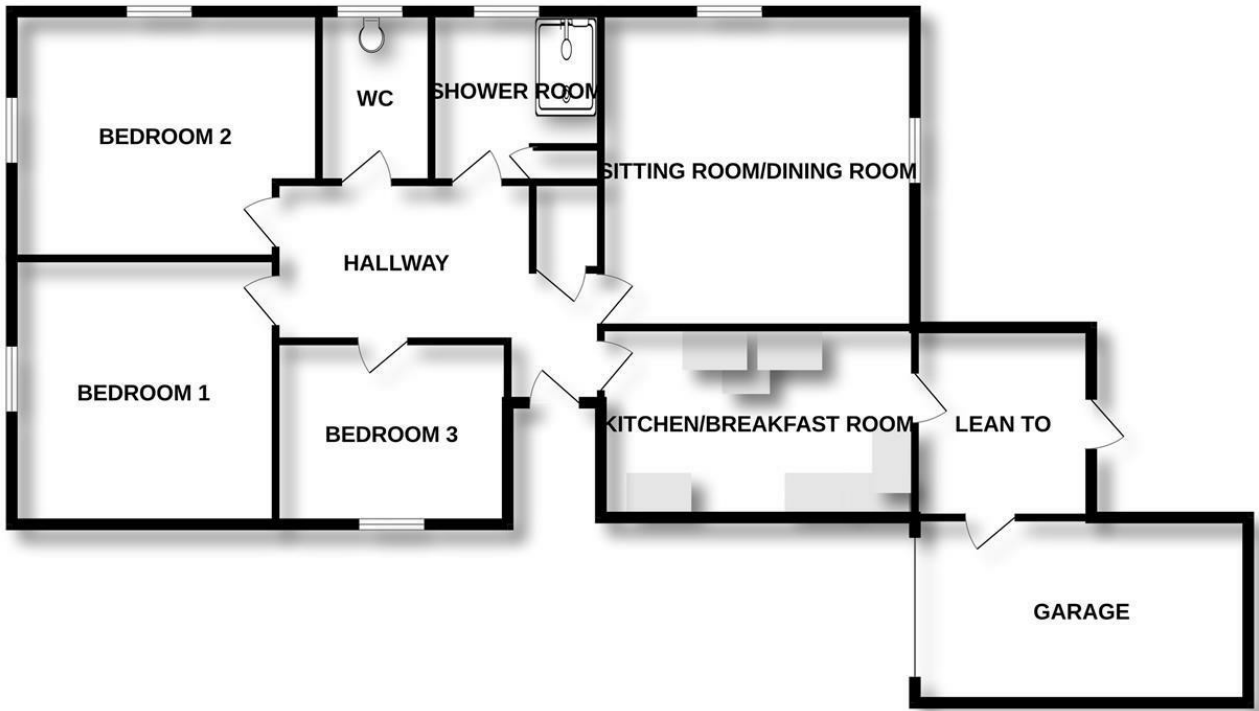

Whilst every attempt has been made to ensure the accuracy of the floorplan contained here, measurements of doors, windows, rooms and any other items are approximate and no responsibility is taken for any error, omission or mis-statement. This plan is for illustrative purposes only and should be used as such by any prospective purchaser. The services, systems and appliances shown have not been tested and no guarantee as to their operability or efficiency can be given.
Made with Metropix ©2023

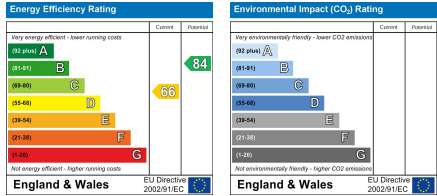

This document and any marketing relating to the property has been prepared in good faith to give a fair overall view of the property and must not be relied upon as statements or representations of fact. It is suggested that undertake enquiries by inspections, survey or other investigation to ascertain the viability of any purchase. Any areas, measurements or distances referred to are given as a guide only and are not precise and no liability can be accepted for errors arising them therefrom. Photographs are not necessarily comprehensive nor current; no assumption should be made that any contents shown are included in the sale. Morris Armitage have not tested any services or equipment and nothing in these particulars should be deemed to be a statement that they are in good working order nor that the property is in good structural condition.

