



Mill Lane
Fordham, Cambridgeshire CB7 5NQ
Guide Price £600,000

Mill Lane, Fordham, Cambridgeshire CB7 5NQ

Occupying a generous size plot, this deceptively spacious modern bungalow is set within the heart of the village with gardens backing on to the river.

This superbly presented home offers versatile accommodation throughout comprising an entrance hall, dual aspect sitting room, kitchen/dining room, four bedrooms (with en-suite bathroom to the master bedroom) four-piece bathroom, cloakroom, utility and conservatory.

Complete with gated frontage boasting ample parking with dual side access and generous rear garden.

Council Tax Band E (East Cambridgeshire)
EPC (D)

Entrance Hall

Spacious entrance hall with storage cupboard leading through to:

Living Room 27'7 x 14'3 (8.41m x 4.34m)

Generously sized living room with windows to the front and side aspect, wood burning stove with solid wood mantelpiece over.

Kitchen/Dining Room 23'4 x 12'5 (7.11m x 3.78m)

Open plan kitchen/dining area with sliding doors leading to the outside patio area. Fitted base and eye level units, wooden worktops with tiled splashback, integrated appliances including 2 ovens, induction hob with extractor fan and tiled flooring and with access to the utility room.

Utility Room 7'8 x 7'6 (2.34m x 2.29m)

With space and plumbing for a washing machine, space for tumble dryer and fridge/freezer and access door though to the cloakroom.

Cloakroom

Cloakroom with low level WC and hand wash basin sink.

Conservatory 16'4 x 11'6 (4.98m x 3.51m)

With French doors leading to the garden.

Bedroom 1 13' x 9'7 (3.96m x 2.92m)

With window to the side aspect, fitted wardrobes, radiator and door leading through to:

En-Suite

With low level WC, hand wash basin, tiled wall in shower cubicle and window to the side aspect.

Bedroom 2 13' x 8'6 (3.96m x 2.59m)

With two storage cupboards, radiator and window to the side aspect.

Bedroom 3 11'10 x 11'3 (3.61m x 3.43m)

With fitted wardrobe and window to the side aspect.

Bedroom 4 11'1 x 9'6 (3.38m x 2.90m)

With wooden flooring, radiator and window to the side aspect.

Family Bathroom

Well finished with solid wood floor, bath with shower attachment over, separate tiled shower cubicle, hand wash basin, WC and heated towel rail.

Outside - Front

Spacious paved driveway along with gated access to rear garden by either side of the property.

Outside - Rear

Fully enclosed, fenced and particularly private rear garden backing on to the river, with seating area and wooden garden shed.

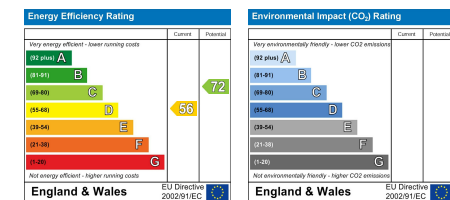
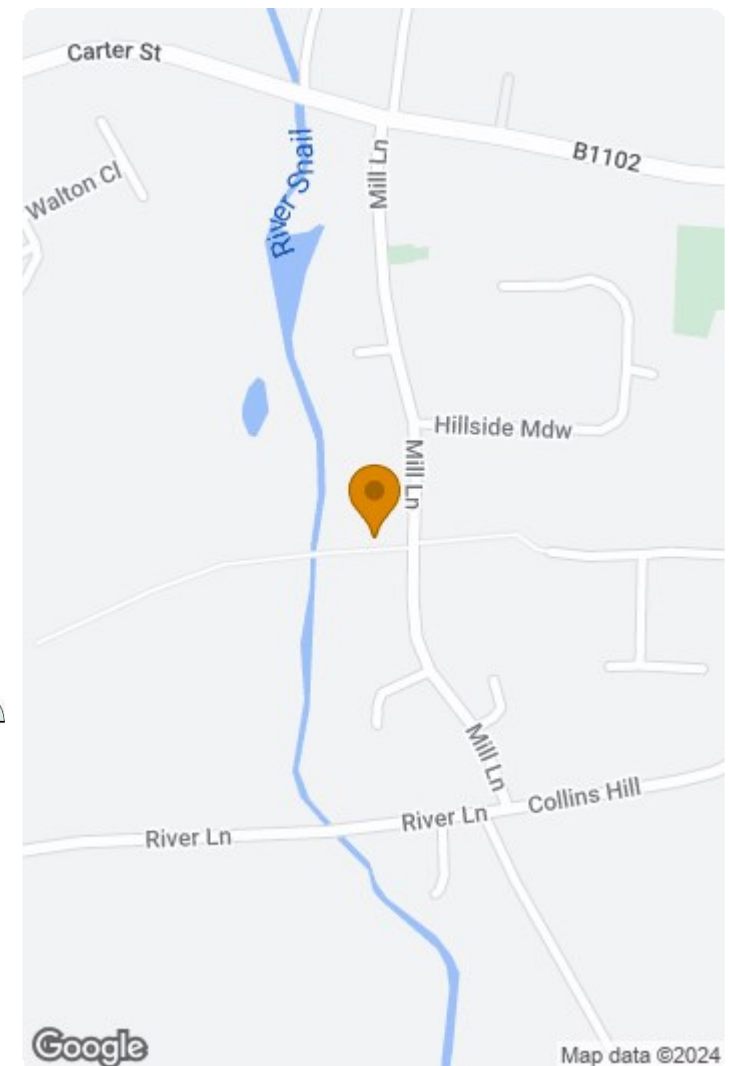
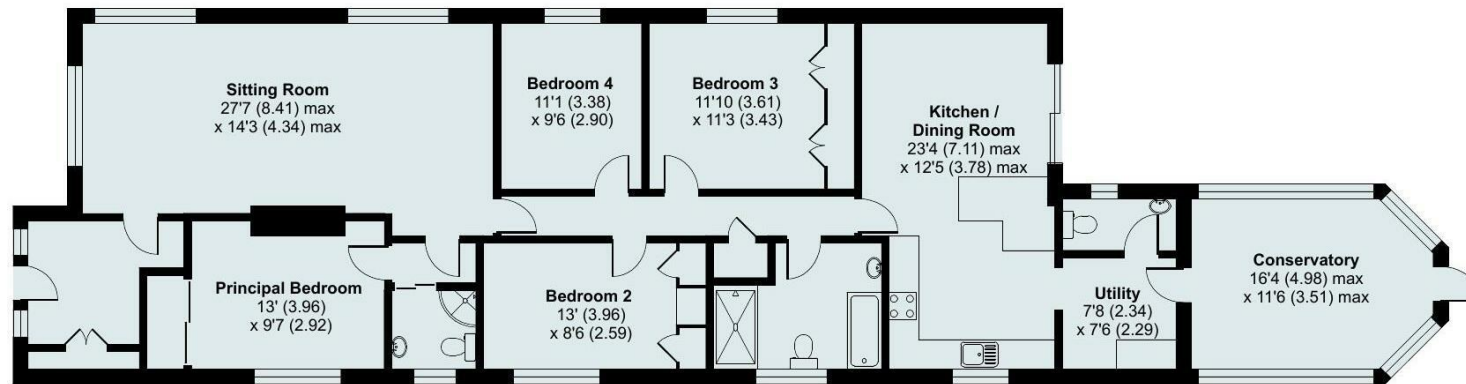

This document and any marketing relating to the property has been prepared in good faith to give a fair overall view of the property and must not be relied upon as statements or representations of fact. It is suggested that undertake enquiries by inspections, survey or other investigation to ascertain the viability of any purchase. Any areas, measurements or distances referred to are given as a guide only and are not precise and no liability can be accepted for errors arising them therefrom. Photographs are not necessarily comprehensive nor current; no assumption should be made that any contents shown are included in the sale. Morris Armitage have not tested any services or equipment and nothing in these particulars should be deemed to be a statement that they are in good working order nor that the property is in good structural condition.





